

EMBOSSSED TAPE CONTAINER

This specifications provide for the specification when NEC MP-3Z power device is done in the embossed taping and it delivers.

REGULATED ITEM

1. Product name display

- 1-1. Method of displaying product name
- 1-2. Device orientation
- 1-3. Example of product name

2. Taping specification

- 2-1. Taping shape and size
- 2-2. Reel shape and size
- 2-3. Other specifications concerning taping

3. Packing

- 3-1. Packing Quantity
- 3-2. Product name,Quantity display
- 3-3. Exterior of reel

EMBOSSSED TAPE CONTAINER

1. Product name

It provides for the taping specification as follows.

1 – 1. Method of displaying product name

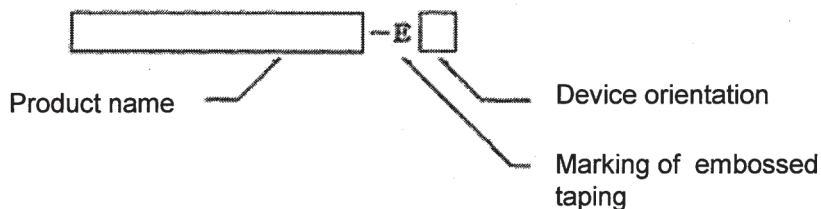

1 – 2. Device orientation

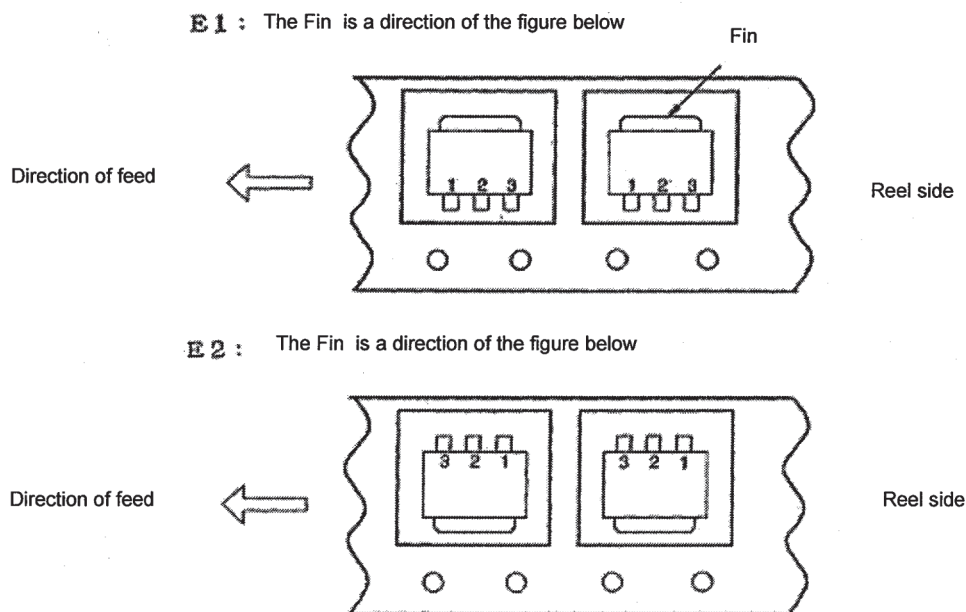

1 – 3. Example of product name

2SK3484-Z-E1 : Embossed taping of 2SK3484-Z of which gate terminal is Faced to feed direction.

2SK3484-Z-E2 : Embossed taping of 2SK3484-Z of which source terminal is Faced to feed direction.

EMBOSED TAPE CONTAINER

2. Taping specification

2-1. Taping shape and size

As for this carrier tape, the electrification prevention processing is given.

- E 1 type

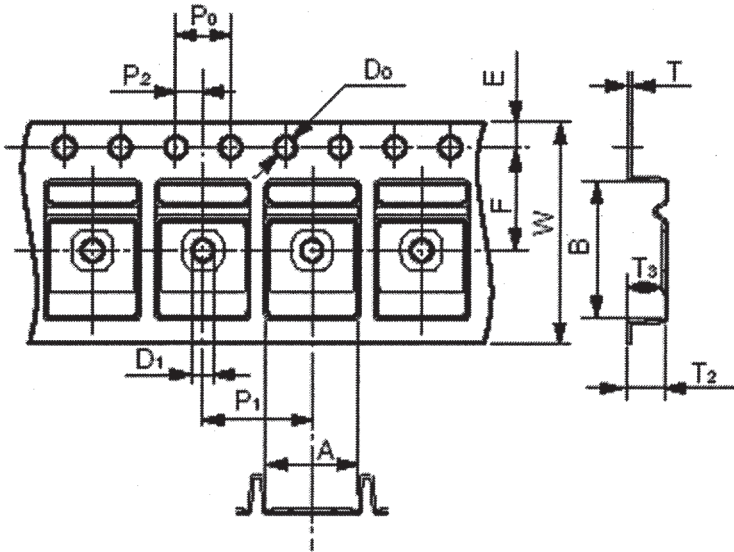

- E 2 type

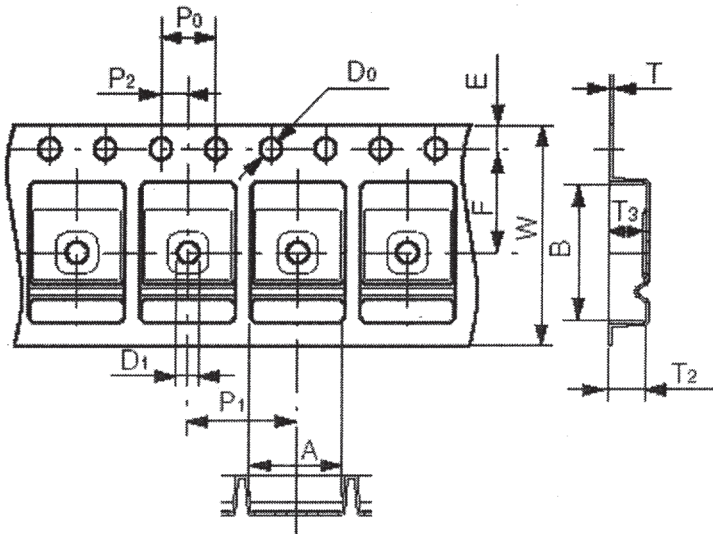

UNIT : mm

SYMBOL	SIZE
A	7.1 MAX.
B	10.7 MAX.
D ₀	$\phi 1.5^{+0.1}_{-0}$
D ₁	$\phi 1.5$ MIN.
E	1.75±0.1
F	7.5±0.1
P ₀	4.0±0.1
P ₁	8.0±0.1
P ₂	2.0±0.1
T	0.3
T ₂	2.7
T ₃	2.5
W	16.0±0.3

EMBOSSED TAPE CONTAINER

2-2. Reel shape and size

As for this reel, the electrification prevention processing is given.

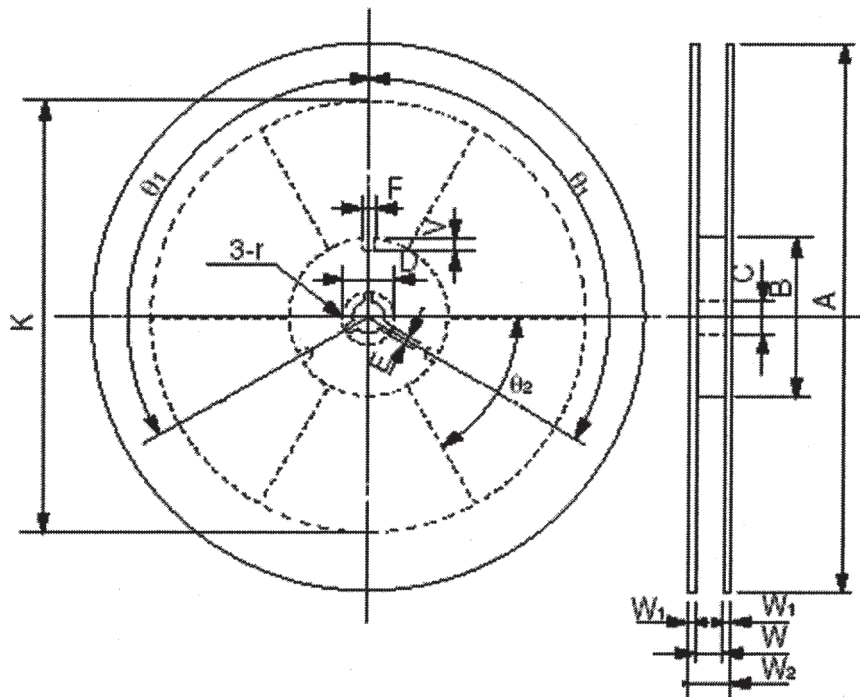

UNIT : mm

SYMBOL	SIZE
A	330
B	100
C	13±0.2
D	21±0.8
E	2.0±0.5
F	2
V	8
W	17.5
W ₁	2.0±0.5
W ₂	22.4 MAX.
K	260
r	1.0
θ ₁	120
θ ₂	60

EMBOSED TAPE CONTAINER

2 – 3. Other specifications concerning taping

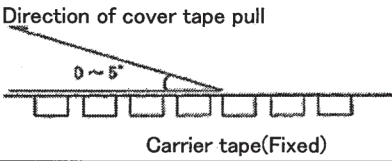
ITEM	SPECIFICATIONS	
Processing of Trailer part(Beginning tape rolling)(Note)	Cover tape	It draws out by 500mm or more, and the point is fixed to the reel with the Scotch tape.
	Carrier tape	Empty carrier is opened by 40mm or more.
Leader part(Finishing tape rolling)(Note)	Cover tape	It draws out the lowest reel once, and the point is fixed to the reel with the Scotch tape.
	Carrier tape	Empty carrier is opened by 500mm or more.
Tape patch	Neither the cover tape nor the carrier tape are patched.	
Cover tape adhesion(Reference value)	<p data-bbox="475 1106 906 1128">0.4±0.3N at peel speed 300±10mm/min.</p>  <p data-bbox="614 1151 879 1173">Direction of cover tape pull</p> <p data-bbox="683 1211 735 1234">0 ~ 5°</p> <p data-bbox="759 1283 943 1305">Carrier tape(Fixed)</p>	
Product omission	Non-continuous omission	0.1% or less excluding the leader part and trailer.
	Continuous omission	Be not excluding the leader part and trailer.

EMBOSED TAPE CONTAINER

(Note) Trailer part, Leader part

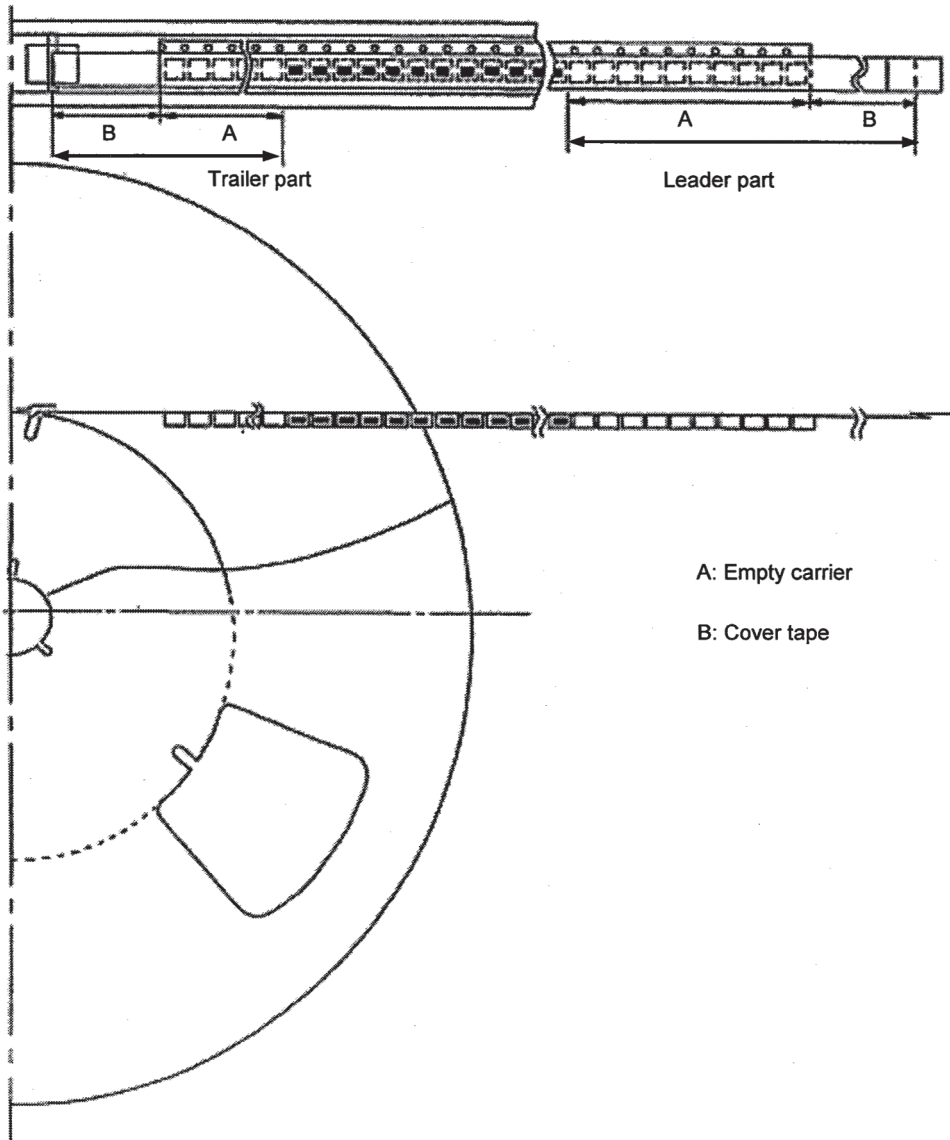

EMBOSSSED TAPE CONTAINER

3. Packing

3-1. Packing Quantity

The number of packing of elements a reel is 2000+3 pcs and -0 pcs.

3-2. Product name,Quantity display

The product name,the Quantity,and the lot(code in which the manufacturing years are shown)are written on the reel side.

3-3. Exterior of reel

The reel that has been packed is stored in the exterior made of the corrugated cardboard box by tow reels usually.

The product name,the Quantity,and lot(code in which the manufacturing years are shown)are written on the exterior box side.

When unavoidably becoming on reel storage,the aircap that did an empty reel or the electrification prevention processing is used as buffer material.