

Plastic Packages for Integrated Circuits

Low Plastic Quad Flatpack Exposed Pad Package (LQFP-EP)

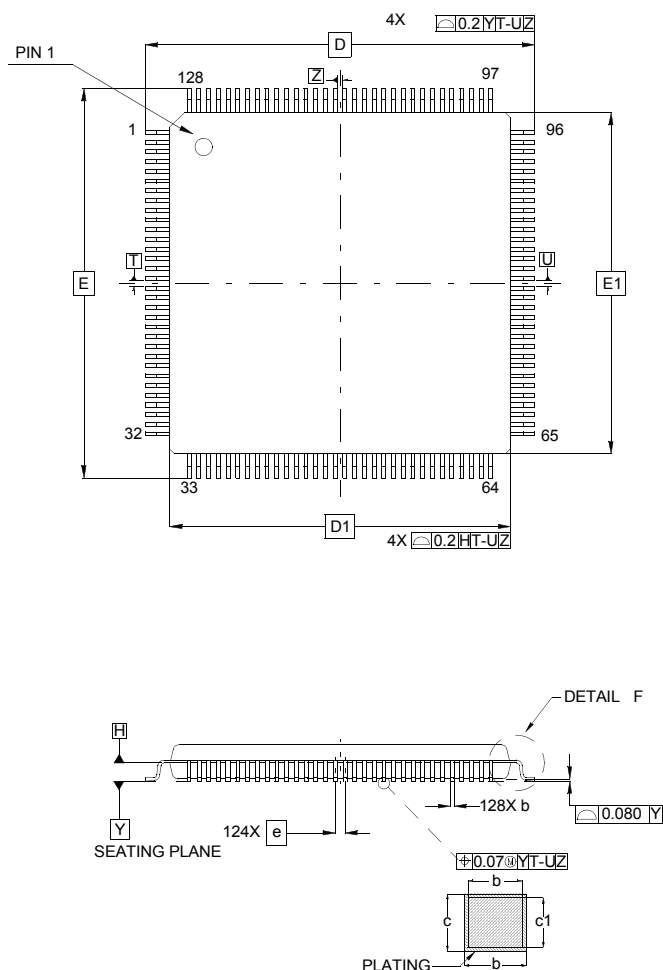

Q128.14x14A

128 Lead Low Plastic Quad Flatpack Exposed Pad Package
(0.4mm pitch)

SYMBOL	MILLIMETERS			NOTES
	MIN	NOM	MAX	
A	-	-	1.60	
A1	0.05	-	0.15	
A2	1.35	1.40	1.45	
b	0.13	0.18	0.23	4
b1	0.13	0.16	0.19	
c	0.09	-	0.20	
c1	0.09	-	0.16	
D	16 BSC			
D1	14 BSC			3
E	16 BSC			4
E1	14 BSC			3
L	0.45	0.60	0.75	
L1	1.00 REF			
R1	0.08	-	-	
R2	0.08	-	0.20	
S	0.20	-	-	
θ	0°	3.5°	7.0°	
θ1	0°	-	-	
θ2	11°	12°	13°	
θ3	11°	12°	13°	
e	0.40 BSC			
M	6.855	6.955	7.055	
N	6.855	6.955	7.055	

Rev. 1 7/11

NOTES:

- Dimensions are in millimeters.
Dimensions in () for Reference Only.
- Dimensioning and tolerancing conform to AMSE Y14.5m-1994.
- Dimensions D1 and E1 are excluding mold protrusion. Allowable protrusion is 0.25mm per side. Dimensions D1 and E1 are inclusive of mold mismatch and determined by datum plane H.
- Dimension b does not include dambar protrusion. Allowable dambar protrusion shall not cause the lead width to exceed the maximum b dimension by more than 0.08mm. Dambar cannot be located at the lower radius or the foot. Minimum space between protrusion and an adjacent lead is 0.07mm.

