

# 160-PIN PLASTIC QFP (28x28)

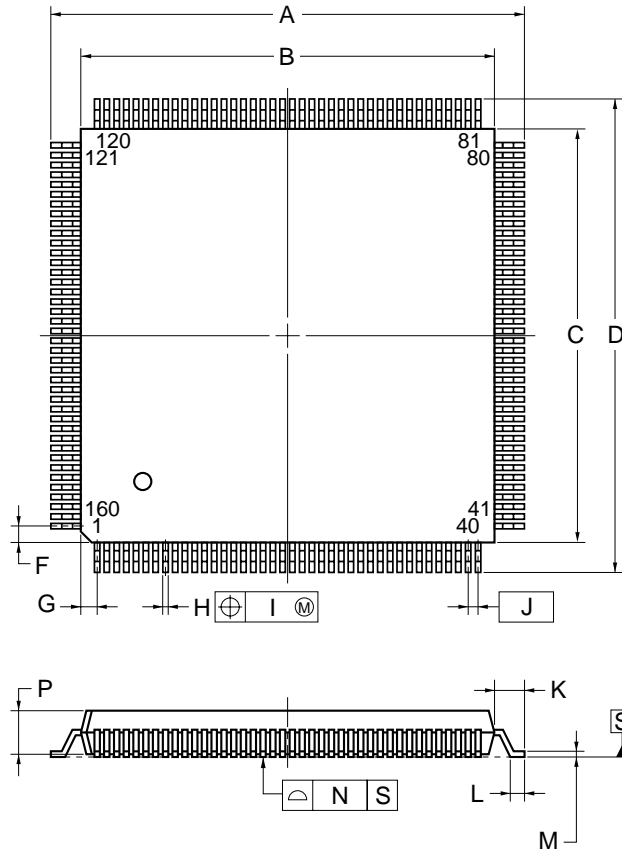

detail of lead end

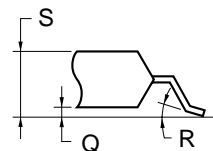

## NOTE

Each lead centerline is located within 0.15 mm of its true position (T.P.) at maximum material condition.

ITEM	MILLIMETERS
A	32.0±0.4
B	28.0±0.2
C	28.0±0.2
D	32.0±0.4
F	1.3
G	1.3
H	0.30±0.10
I	0.15
J	0.65 (T.P.)
K	2.0±0.2
L	0.8±0.2
M	0.15 <sup>+0.10</sup> <sub>-0.05</sub>
N	0.10
P	3.7
Q	0.1±0.1
R	5°±5°
S	4.0 MAX.

P160GD-65-5BD-4