

32-PIN PLASTIC QFJ (14.04x11.5)

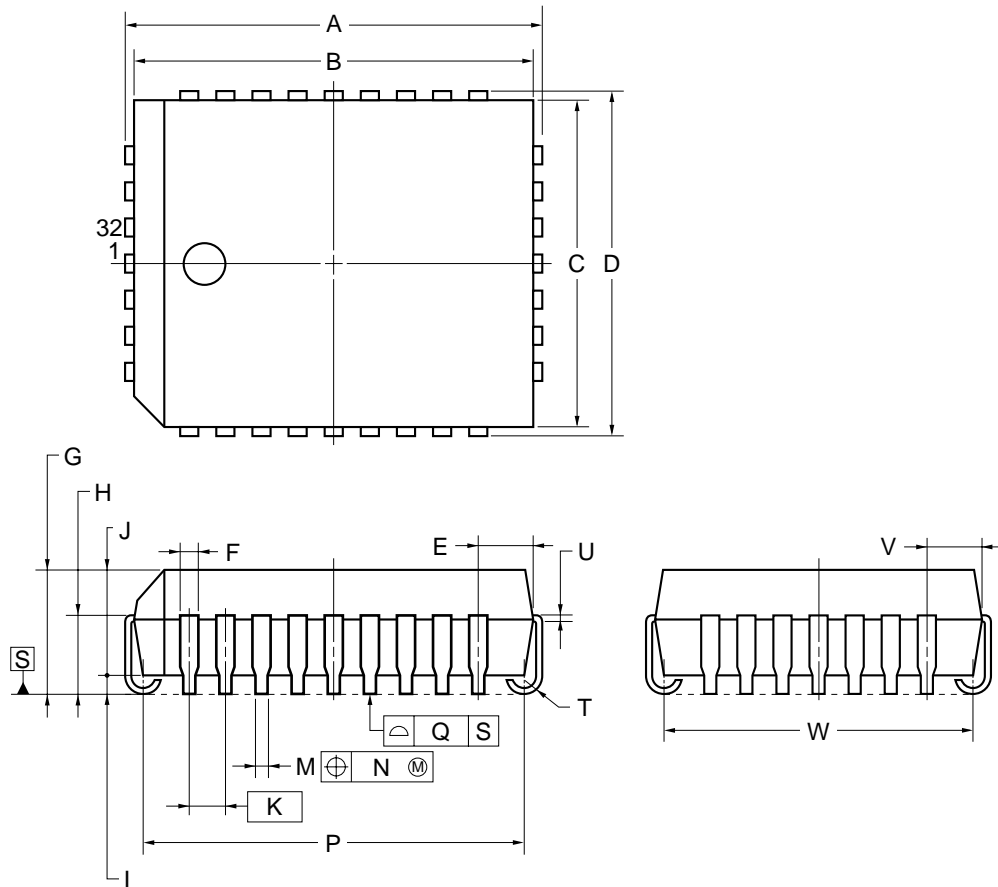

NOTE

Each lead centerline is located within 0.12 mm of its true position (T.P.) at maximum material condition.

| ITEM | MILLIMETERS |
|------|----------------------------------------|
| A | 14.99±0.2 |
| B | 14.04±0.1 |
| C | 11.50±0.1 |
| D | 12.45±0.2 |
| E | 1.94±0.15 |
| F | 0.6 |
| G | 4.4±0.2 |
| H | 2.8±0.2 |
| I | 0.9 MIN. |
| J | 3.4±0.1 |
| K | 1.27 (T.P.) |
| M | 0.42±0.08 |
| N | 0.12 |
| P | 12.95±0.2 |
| Q | 0.15 |
| T | R 0.8 |
| U | 0.22 ^{+0.08} _{-0.07} |
| V | 1.94±0.15 |
| W | 10.42 |