

184-PIN PLASTIC QFP (32x32)

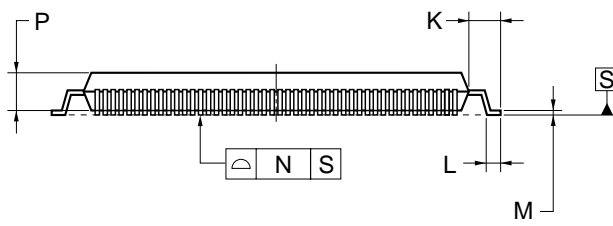
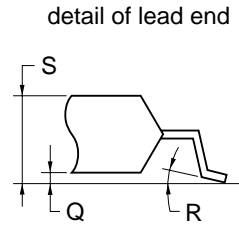
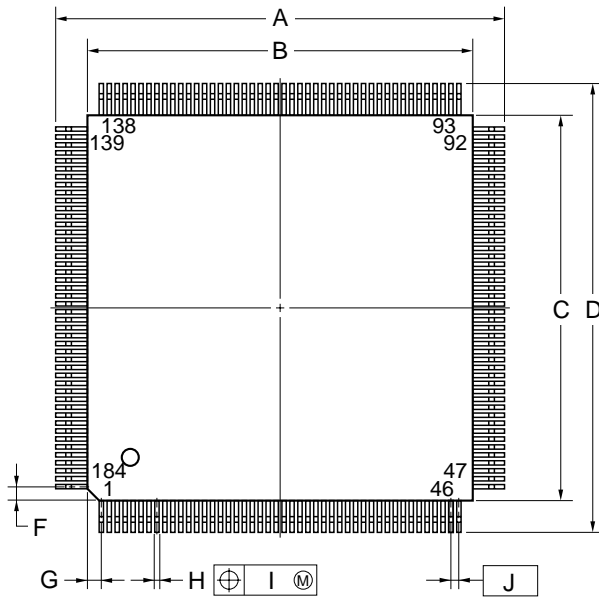

NOTE

Each lead centerline is located within 0.13 mm of its true position (T.P.) at maximum material condition.

ITEM	MILLIMETERS
A	35.2±0.3
B	32.0±0.2
C	32.0±0.2
D	35.2±0.3
F	1.375
G	1.375
H	0.30±0.10
I	0.13
J	0.65 (T.P.)
K	1.6±0.2
L	0.8±0.2
M	0.15±0.05
N	0.10
P	3.2
Q	0.4±0.1
R	5°±5°
S	3.8 MAX.

P184GN-65-LGT-2