

64PIN PLASTIC QFP (14×20)

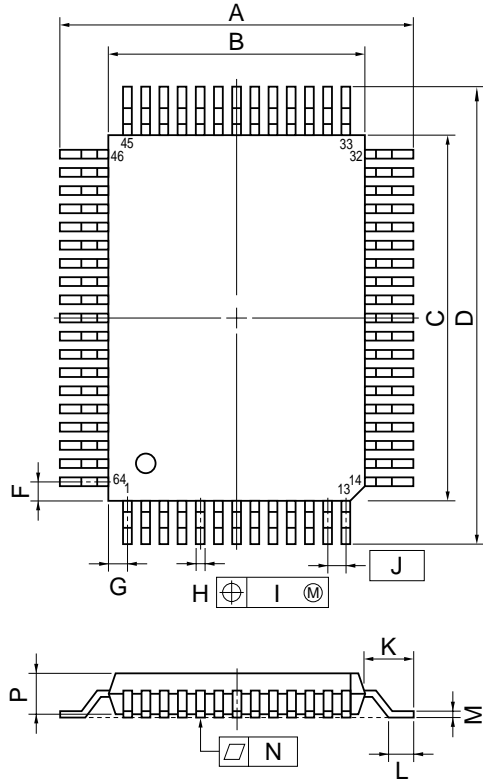

detail of lead end

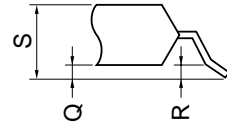

NOTE

Each lead centerline is located within 0.20 mm (0.008 inch) of its true position (T.P.) at maximum material condition.

ITEM	MILLIMETERS	INCHES
A	18.7±0.4	0.736±0.016
B	14.0±0.2	0.551 ^{+0.009} _{-0.008}
C	20.0±0.2	0.795 ^{+0.009} _{-0.008}
D	24.7±0.4	0.972 ^{+0.017} _{-0.016}
F	1.0	0.039
G	1.0	0.039
H	0.40±0.10	0.016 ^{+0.004} _{-0.005}
I	0.20	0.008
J	1.0 (T.P.)	0.039 (T.P.)
K	2.35±0.2	0.093 ^{+0.008} _{-0.009}
L	1.2±0.2	0.047 ^{+0.009} _{-0.008}
M	0.15 ^{+0.10} _{-0.05}	0.006 ^{+0.004} _{-0.003}
N	0.15	0.006
P	2.05 ^{+0.2} _{-0.1}	0.081 ^{+0.008} _{-0.005}
Q	0.1±0.1	0.004±0.004
R	0.1±0.1	0.004±0.004
S	2.45 MAX.	0.097 MAX.