

100-PIN PLASTIC TQFP (FINE PITCH) (12x12)

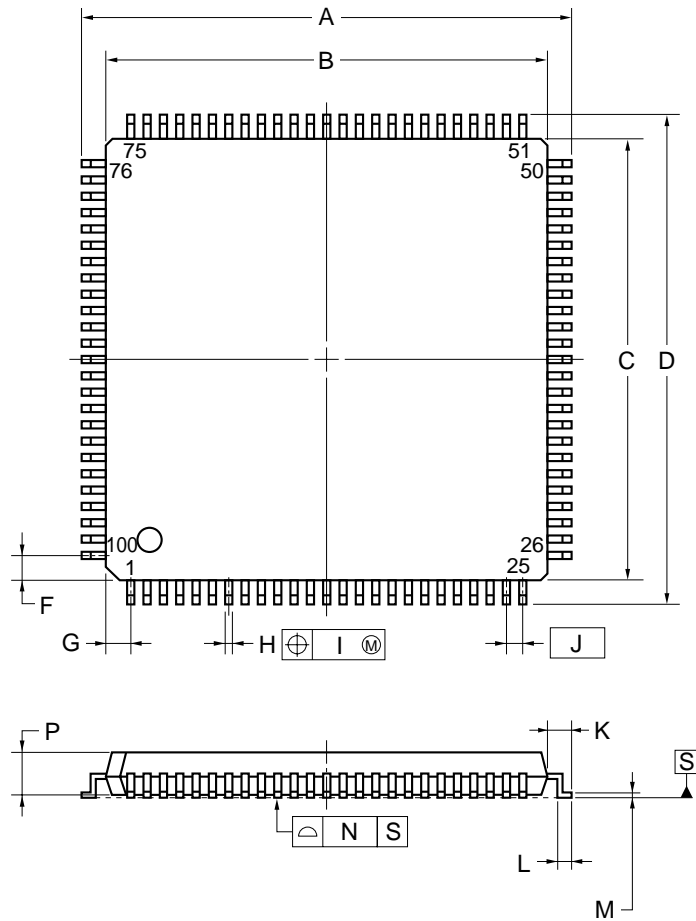

NOTE

Each lead centerline is located within 0.07 mm of its true position (T.P.) at maximum material condition.

ITEM	MILLIMETERS
A	14.00±0.20
B	12.00±0.20
C	12.00±0.20
D	14.00±0.20
F	1.20
G	1.20
H	0.18±0.05
I	0.07
J	0.40 (T.P.)
K	1.00±0.20
L	0.50±0.20
M	0.145±0.05
N	0.08
P	1.00±0.05
Q	0.10±0.05
R	3° ^{+7°} -3°
S	1.2 MAX.

S100GK-40-9EV-1