

40-PIN PLASTIC QFP (9.5x9.5)

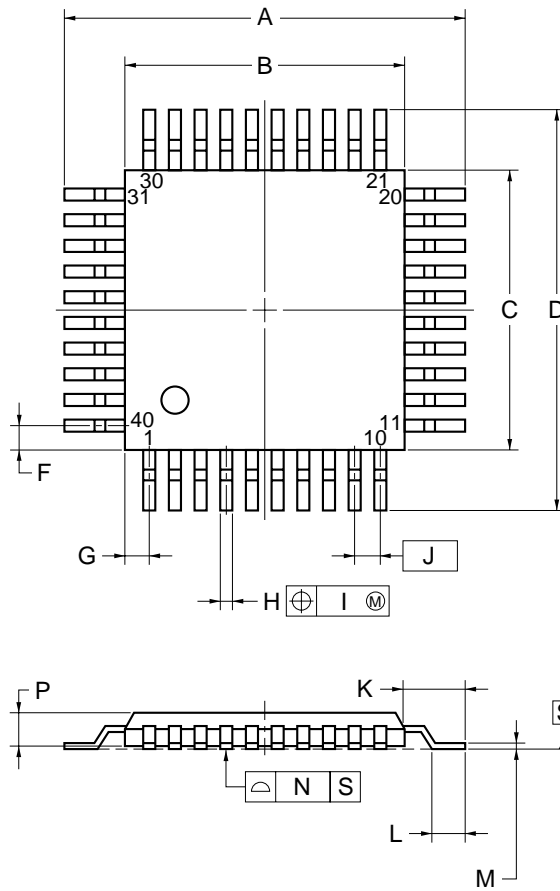

detail of lead end

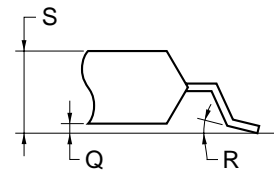

NOTE

Each lead centerline is located within 0.15 mm of its true position (T.P.) at maximum material condition.

| ITEM | MILLIMETERS |
|------|--|
| A | 13.5±0.4 |
| B | 9.5±0.2 |
| C | 9.5±0.2 |
| D | 13.5±0.4 |
| F | 1.15 |
| G | 1.15 |
| H | 0.40±0.10 |
| I | 0.15 |
| J | 0.8 (T.P.) |
| K | 2.0±0.2 |
| L | 1.2±0.2 |
| M | 0.15 ^{+0.10} _{-0.05} |
| N | 0.15 |
| P | 1.5±0.1 |
| Q | 0.1±0.1 |
| R | 3° ^{+7°} _{-3°} |
| S | 1.8 MAX. |

P40G-80-F-3