

JEITA Package Code	RENESAS Code	Previous Code	MASS (TYP.) [g]
P-LFQFP216-24x24-0.40	PLQP0216LF-D	S216GM-40-8EV-2	2.01

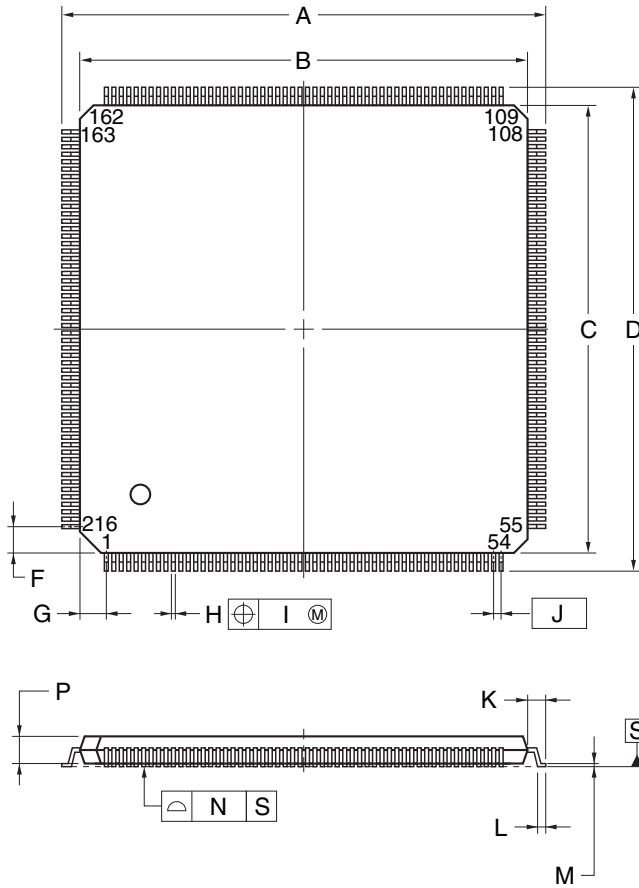

detail of lead end

ITEM	MILLIMETERS
A	26.00±0.20
B	24.00±0.20
C	24.00±0.20
D	26.00±0.20
F	1.40
G	1.40
H	0.18±0.05
I	0.07
J	0.40 (T.P.)
K	1.00±0.20
L	0.50±0.20
M	0.145 ^{+0.055} _{-0.045}
N	0.08
P	1.40 ^{+0.10} _{-0.05}
Q	0.125±0.075
R	3° ^{+7°} _{-3°}
S	1.70 MAX.

NOTE

Each lead centerline is located within 0.07 mm of its true position (T.P.) at maximum material condition.